



EDSUKPB2 Power Pole Power Bollard



Outline Specification: EDSUKPB2 Power Bollard

Raise Height	500 - 1000mm. (Subject to specification & client requirements)
Bollard Diameter Width	150 - 600mm. (Subject to specification & client requirements)
Construction	Steel or Stainless Steel Construction (Mirror or Satin).
Finish	Hot Dipped Galvanised Finish, Shotblasted and finished with zinc primer and special 3-part coating system or Powdercoating. Corporate Colours & Designs.
Drive Unit	Manual Lift Assist, with key, push down to close. Options to have the bollards electrically raised and lowered.
Power	Single Phase or Three Phase with single outlet, multiple outlets, distribution boards. All custom made to clients requirements.
Load Rating:	GROUP 1 [1.5 Tons] - GROUP 6 [90 Tons] (class F900): Ports, aircraft runways.
Operating temperature	-20 to +80 degrees Centigrade
Options	Power Outlet Sockets, Data Outlet Sockets, Security Outlets, Water Outlets, Gas Outlets. A large range of options is available as most units are custom made to client's specific requirements.

EDSUKPB2 is a mechanically (or optional electrical) driven bollard which can incorporate a range of power outlets (with options for security & data) to provide local power where required. The bollards are raised when required by using a simple key raising the bollard automatically from the ground allowing the user to plug in appliances, when finished with the user simply lowers the bollard by placing pressure on the top of the bollard and lock into the lowered position. The bollard consists of a flanged cylinder providing a casing to the rising bollard, an electrical distribution unit (subject to specification) and self assisting spring or arm. The cylinder, to be inserted into a foundation tube cemented into the ground and is firmly secured to the foundation with anchor flanges. Suitable openings in the lower and middle sections of the bollard are provided both to drain possible water residues that may gather inside and for cables access into the bollard for the electrical connections. Additional drains may be required subject to ground engineer's survey. The combination of the colours and finishes provides an aesthetically pleasing bollard. Lights can also be fitted

EDSUKPB2 Power Pole Power Bollard

Technical Specification & Notes:

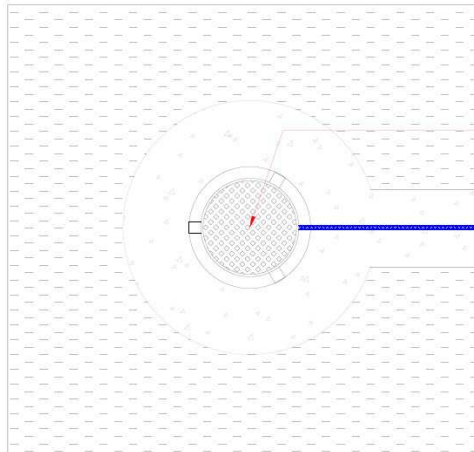
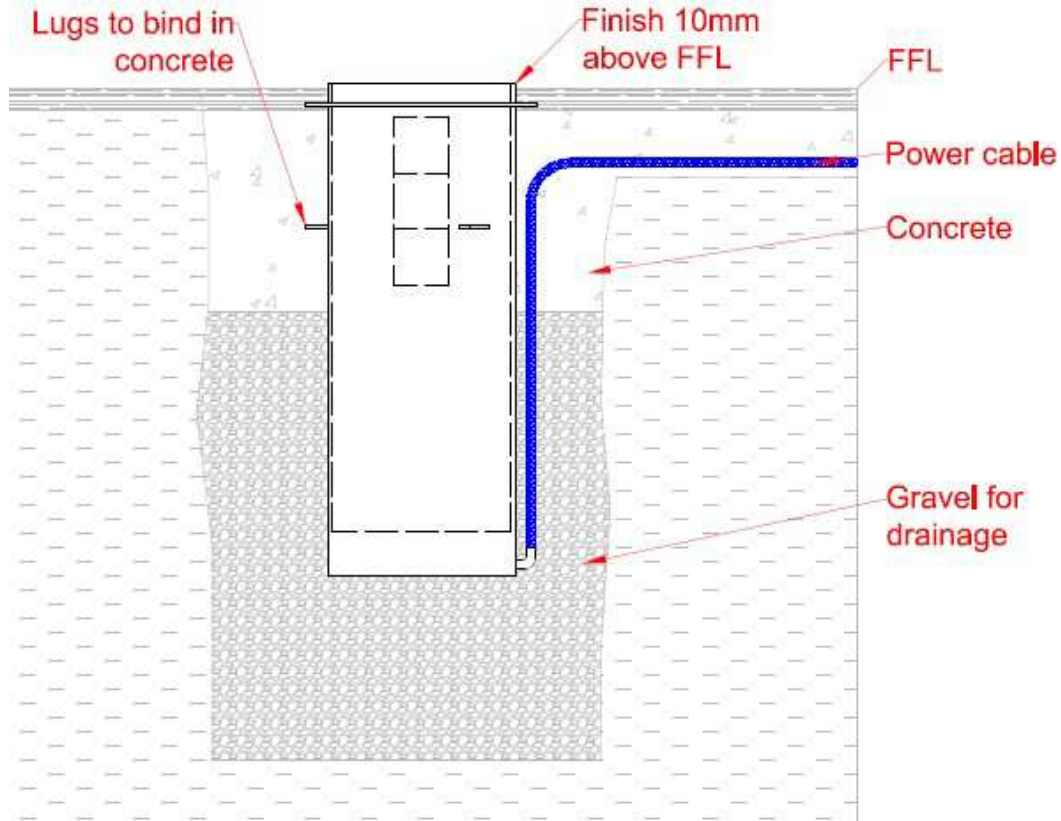

Finishes to requirements

